

RUBINETTI ROTALOCK CON ODS IN USCITA IN RAME - Rotalock Valves with copper outlet ODS

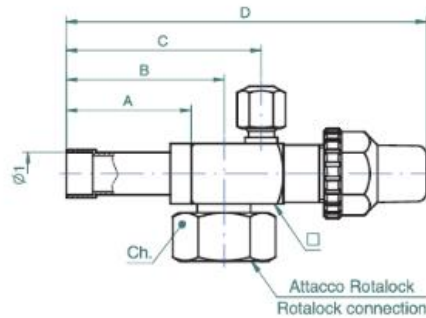

Presse Pressione tipo Cx
Cx Gage port

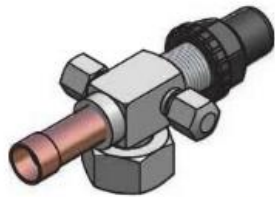

Presse Pressione tipo Sx e Dx in By-Pass
SX Gage port and Dx in By-Pass

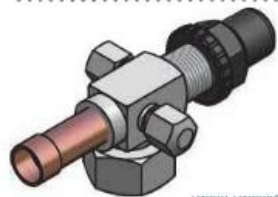

Presse Pressione tipo Dx e Sx in By-Pass
Dx Gage port and Sx in By-Pass



Raccordo Schrader 1/4" SAE
1/4" SAE Schrader connection

| □ | Attacco Rotalock | Uscita ODS | | Presse pressione | By-Pass | Ø1 | A | B | C | D | Ch. |
|-----|------------------|------------|-------|------------------|----------|-----|------|-----|------|-----|-----|
| mm | | mm | inch. | Cx-Sx-Dx | Cx-Sx-Dx | mm | mm | mm | mm | mm | mm |
| □20 | 3/4" -16 UNF | 6 | 1/4" | Cx | | 6,2 | 35 | 46 | 58,5 | 114 | 24 |
| | | | | Sx | Dx | 6,2 | 35 | 46 | 58,5 | 114 | 24 |
| | | | | Dx | Sx | 6,2 | 35 | 46 | 58,5 | 114 | 24 |
| | | | | Cx | | 6,5 | 35 | 46 | 58,5 | 114 | 24 |
| | | | | Sx | Dx | 6,5 | 35 | 46 | 58,5 | 114 | 24 |
| | | | | Dx | Sx | 6,5 | 35 | 46 | 58,5 | 114 | 24 |
| | | 8 | 3/8" | Cx | | 8,2 | 35 | 46 | 58,5 | 114 | 24 |
| | | | | Sx | Dx | 8,2 | 35 | 46 | 58,5 | 114 | 24 |
| | | | | Dx | Sx | 8,2 | 35 | 46 | 58,5 | 114 | 24 |
| | | | | Cx | | 9,7 | 35 | 46 | 58,5 | 114 | 24 |
| | | | | Sx | Dx | 9,7 | 35 | 46 | 58,5 | 114 | 24 |
| | | | | Dx | Sx | 9,7 | 35 | 46 | 58,5 | 114 | 24 |
| 10 | | Cx | | 10,2 | 35 | 46 | 58,5 | 114 | 24 | | |
| | | Sx | Dx | 10,2 | 35 | 46 | 58,5 | 114 | 24 | | |
| | | Dx | Sx | 10,2 | 35 | 46 | 58,5 | 114 | 24 | | |

| □ | Attacco Rotalock | Uscita ODS | | Presse pressione | By-Pass | Ø1 | A | B | C | D | Ch. | | |
|-----|------------------|------------|----------------|------------------|----------|------|------|------|------|-----|-----|-----|----|
| mm | | mm | inch. | Cx-Sx-Dx | Cx-Sx-Dx | mm | mm | mm | mm | mm | mm | | |
| □20 | 1" -14 UNS | 10 | 3/8" | Cx | | 9,7 | 35 | 46 | 58,5 | 114 | 30 | | |
| | | | | Sx | Dx | 9,7 | 35 | 46 | 58,5 | 114 | 30 | | |
| | | | | Dx | Sx | 9,7 | 35 | 46 | 58,5 | 114 | 30 | | |
| | | | | Cx | | 10,2 | 35 | 46 | 58,5 | 114 | 30 | | |
| | | | | Sx | Dx | 10,2 | 35 | 46 | 58,5 | 114 | 30 | | |
| | | | | Dx | Sx | 10,2 | 35 | 46 | 58,5 | 114 | 30 | | |
| | | 12 | | Cx | | 12,2 | 35 | 46 | 58,5 | 114 | 30 | | |
| | | | | Sx | Dx | 12,2 | 35 | 46 | 58,5 | 114 | 30 | | |
| | | | | Dx | Sx | 12,2 | 35 | 46 | 58,5 | 114 | 30 | | |
| | | | | Cx | | 12,8 | 35 | 46 | 58,5 | 114 | 30 | | |
| | | | | Sx | Dx | 12,8 | 35 | 46 | 58,5 | 114 | 30 | | |
| | | | | Dx | Sx | 12,8 | 35 | 46 | 58,5 | 114 | 30 | | |
| 16 | 5/8" | Cx | | 16,2 | 35 | 46 | 58,5 | 114 | 30 | | | | |
| | | Sx | Dx | 16,2 | 35 | 46 | 58,5 | 114 | 30 | | | | |
| | | Dx | Sx | 16,2 | 35 | 46 | 58,5 | 114 | 30 | | | | |
| | | Cx | | 16,2 | 35 | 50 | 64 | 133 | 36 | | | | |
| | | Sx | Dx | 16,2 | 35 | 50 | 64 | 133 | 36 | | | | |
| | | Dx | Sx | 16,2 | 35 | 50 | 64 | 133 | 36 | | | | |
| □22 | 1 1/4" -12 UNF | 18 | 5/8" | Cx | | 18,2 | 52 | 67 | 81 | 150 | 36 | | |
| | | | | Sx | Dx | 18,2 | 52 | 67 | 81 | 150 | 36 | | |
| | | | | Dx | Sx | 18,2 | 52 | 67 | 81 | 150 | 36 | | |
| | | | | Cx | | 19,2 | 52 | 67 | 81 | 150 | 36 | | |
| | | | | Sx | Dx | 19,2 | 52 | 67 | 81 | 150 | 36 | | |
| | | | | Dx | Sx | 19,2 | 52 | 67 | 81 | 150 | 36 | | |
| | | □30 | 1 1/4" -12 UNF | 18 | 3/4" | Cx | | 19,2 | 52 | 69 | 86 | 158 | 36 |
| | | | | | | Sx | Dx | 19,2 | 52 | 69 | 86 | 158 | 36 |
| | | | | | | Dx | Sx | 19,2 | 52 | 69 | 86 | 158 | 36 |
| | | | | | | Cx | | 22,2 | 52 | 69 | 86 | 158 | 36 |
| | | | | | | Sx | Dx | 22,2 | 52 | 69 | 86 | 158 | 36 |
| | | | | | | Dx | Sx | 22,2 | 52 | 69 | 86 | 158 | 36 |
| 22 | | | | Cx | | 22,2 | 52 | 69 | 86 | 158 | 36 | | |
| | | | | Sx | Dx | 22,2 | 52 | 69 | 86 | 158 | 36 | | |
| | | | | Dx | Sx | 22,2 | 52 | 69 | 86 | 158 | 36 | | |
| | | | | Cx | | 22,4 | 52 | 69 | 86 | 158 | 36 | | |
| | | | | Sx | Dx | 22,4 | 52 | 69 | 86 | 158 | 36 | | |
| | | | | Dx | Sx | 22,4 | 52 | 69 | 86 | 158 | 36 | | |
| 28 | | Cx | | 28,2 | 52 | 69 | 86 | 158 | 36 | | | | |
| | | Sx | Dx | 28,2 | 52 | 69 | 86 | 158 | 36 | | | | |
| | | Dx | Sx | 28,2 | 52 | 69 | 86 | 158 | 36 | | | | |
| | | Cx | | 28,8 | 52 | 69 | 86 | 158 | 36 | | | | |
| | | Sx | Dx | 28,8 | 52 | 69 | 86 | 158 | 36 | | | | |
| | | Dx | Sx | 28,8 | 52 | 69 | 86 | 158 | 36 | | | | |
| □35 | 1 3/4" -12 UN | 28 | 1 1/8" | Cx | | 28,2 | 52 | 75 | 98,5 | 201 | 50 | | |
| | | | | Sx | Dx | 28,2 | 52 | 75 | 98,5 | 201 | 50 | | |
| | | | | Dx | Sx | 28,2 | 52 | 75 | 98,5 | 201 | 50 | | |
| | | | | Cx | | 28,8 | 52 | 75 | 98,5 | 201 | 50 | | |
| | | | | Sx | Dx | 28,8 | 52 | 75 | 98,5 | 201 | 50 | | |
| | | | | Dx | Sx | 28,8 | 52 | 75 | 98,5 | 201 | 50 | | |
| | | 35 | 1 3/8" | Cx | | 35,2 | 52 | 75 | 98,5 | 201 | 50 | | |
| | | | | Sx | Dx | 35,2 | 52 | 75 | 98,5 | 201 | 50 | | |
| | | | | Dx | Sx | 35,2 | 52 | 75 | 98,5 | 201 | 50 | | |

| | | |
|---|----------------|----------------|
| MASSIMA PRESSIONE DI LAVORO Maximum working pressure | PS 50 bar | PS 37 bar |
| TEMPERATURA AMMISSIBILE Permissible temperature | TS -10/+150 °C | TS -40/+150 °C |
| PRESSIONE DI COLLAUDO Testing pressure | PT 71,5 bar | |
| FLUIDO REFRIGERANTE Refrigerant | GROUP 2 PED | |
| CATEGORIA PED Category PED | ARTICLE 3.3 | |
| TRATTAMENTO SUPERFICIALE: RAMATURA, NICHELATURA O STAGNATURA. Surface treatment: copper, nickel or tin plated. | | |