



**Capacity (EN 12900/CECOMAF)**
**watt**

Comp.\°C	-25	-23.3	-20	-15	-10	-5	0	5	7.2	10	15
SC15G	164	206	290	424	568	728	908	1110	1207	1340	1600

**Capacity (ASHRAE)**
**watt**

Comp.\°C	-25	-23.3	-20	-15	-10	-5	0	5	7.2	10	15
SC15G	203	255	358	523	703	901	1124	1377	1499	1665	1993

**Power consumption**
**watt**

Comp.\°C	-25	-23.3	-20	-15	-10	-5	0	5	7.2	10	15
SC15G	233	259	307	376	440	497	549	595	613	634	667

**Current consumption**
**A**

Comp.\°C	-25	-23.3	-20	-15	-10	-5	0	5	7.2	10	15
SC15G	2.21	2.28	2.40	2.59	2.78	2.99	3.20	3.42	3.52	3.64	3.88

**COP (EN 12900/CECOMAF)**
**W/W**

Comp.\°C	-25	-23.3	-20	-15	-10	-5	0	5	7.2	10	15
SC15G	0.71	0.80	0.95	1.13	1.29	1.46	1.65	1.87	1.97	2.11	2.40

**COP (ASHRAE)**
**W/W**

Comp.\°C	-25	-23.3	-20	-15	-10	-5	0	5	7.2	10	15
SC15G	0.87	0.99	1.17	1.39	1.60	1.81	2.05	2.31	2.44	2.62	2.99

Test conditions

EN 12900/CECOMAF

ASHRAE

Condensing temperature

55°C

55°C

Ambient and suction gas temp.

32°C

32°C

Liquid temperature

55°C

32°C

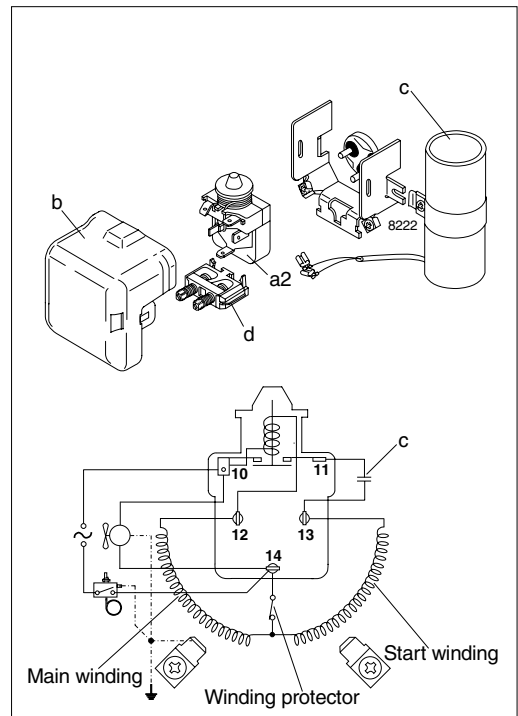
 Fan cooling  $F_{21}$ , 220V 50Hz

**Accessories**

Devices	Fig.	SC15G
Starting relay	a2	117U6005
Cover	b	103N2009
Starting capacitor 80 µF	c	117U5017
Cord relief	d	103N1004
Mounting accessories		
Bolt joint for one compressor		118-1917
Bolt joint in quantities		118-1918
Snap-on in quantities		118-1919

Danfoss can accept no responsibility for possible errors in catalogues, brochures and other printed material. Danfoss reserves the right to alter its products without notice. This also applies to products already on order provided that such alterations can be made without subsequential changes being necessary in specifications already agreed. All trademarks in this material are property of the respective companies. Danfoss and the Danfoss logotype are trademarks of Danfoss A/S. All rights reserved.